

HILLSDALE COUNTY ROAD COMMISSION
HILLSDALE, MICHIGAN
 CERTIFICATION AS OF DECEMBER 31, 2021

<u>Township</u>	<u>Sheet Numbers</u>	<u>Township</u>	<u>Sheet Numbers</u>	<u>Township</u>	<u>Sheet Numbers</u>
Title Sheet	1	Jefferson	20-24	Wheatland	44
Adams	2-3	Litchfield	25	Woodbridge	45-46
Allen	4	Moscow	26	Wright	47-48
Amboy	5-8	Pittsford	23 & 27	Adams URBAN	49
Cambria	9-11	Ransom	28-29	Cambria URBAN	50
Camden	12-14	Reading	30-35	Fayette URBAN	51
Fayette	15-16	Scipio	36-38	Hillsdale URBAN	51-53
Hillsdale	15, 17-19	Somerset	39-43	Jefferson URBAN	54-56

“I certify that all of the roads on which lengths have been entered along the road bands of the attached township and enlarged section maps are normally open to automobile traffic during the months of May through October and are under the jurisdiction of the Hillsdale County Road Commission.”

January 10, 2022

 John Sanders, Manager

LEGEND

- Twp or County Line -----
- Corporate Limits _____
- State Trunkline —————
- County Primary —————
- County Local —————
- Adjacent County XXXXXXXXXXXXXXXX

Total Feet 12,356 equals 2.34 miles.

I HEREBY CERTIFY THAT THE ROADS SHOWN HEREON BY SYMBOL OR IN BLUE AS LOCAL ROADS ARE IN USE AND ARE UNDER THE JURISDICTION OF THE COUNTY ROAD COMMISSION.

Chairman Date

ADAMS TWP

Section 17, T6S, R2W
Hillsdale County

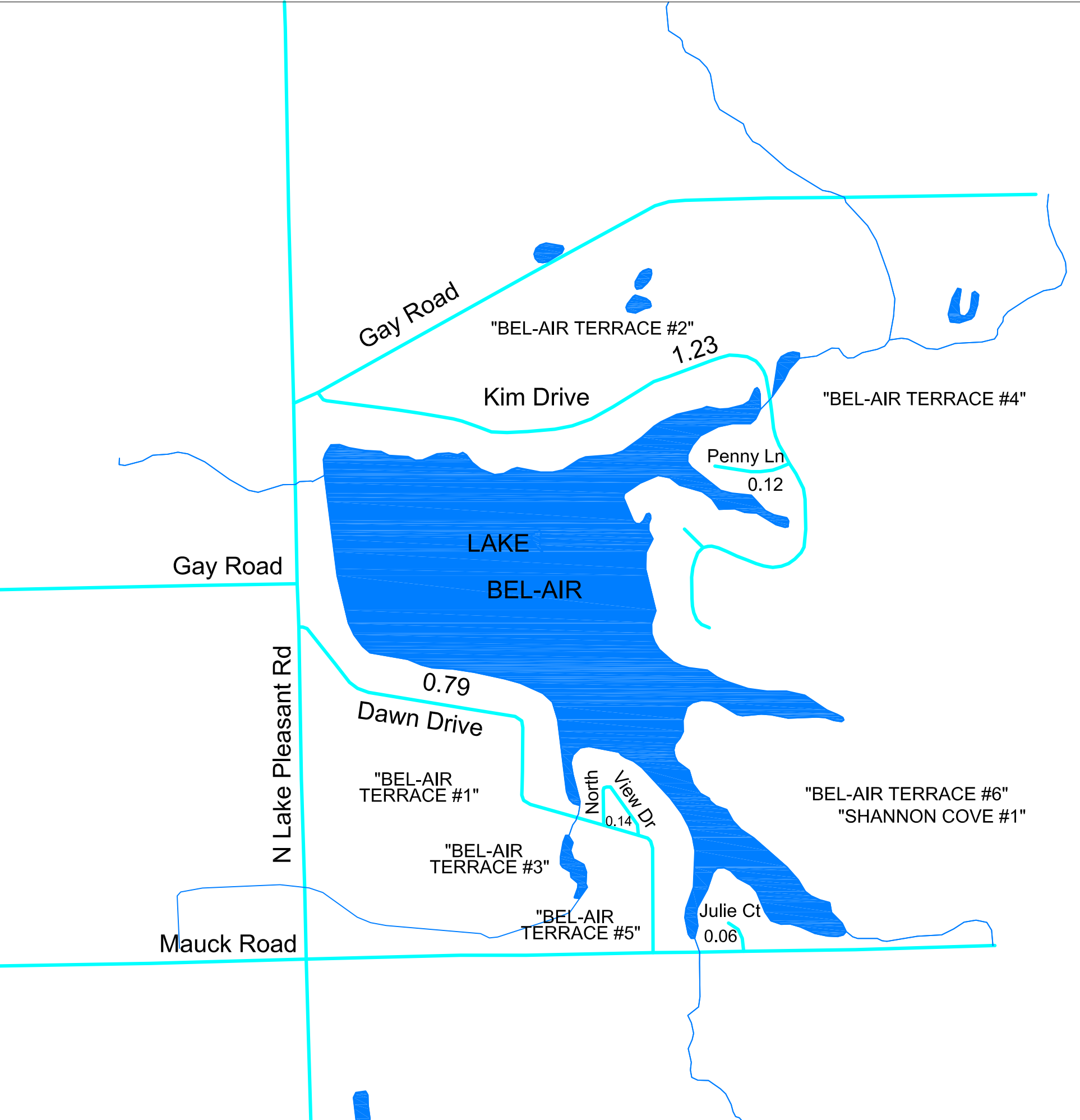
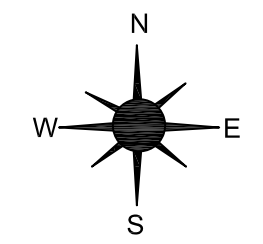

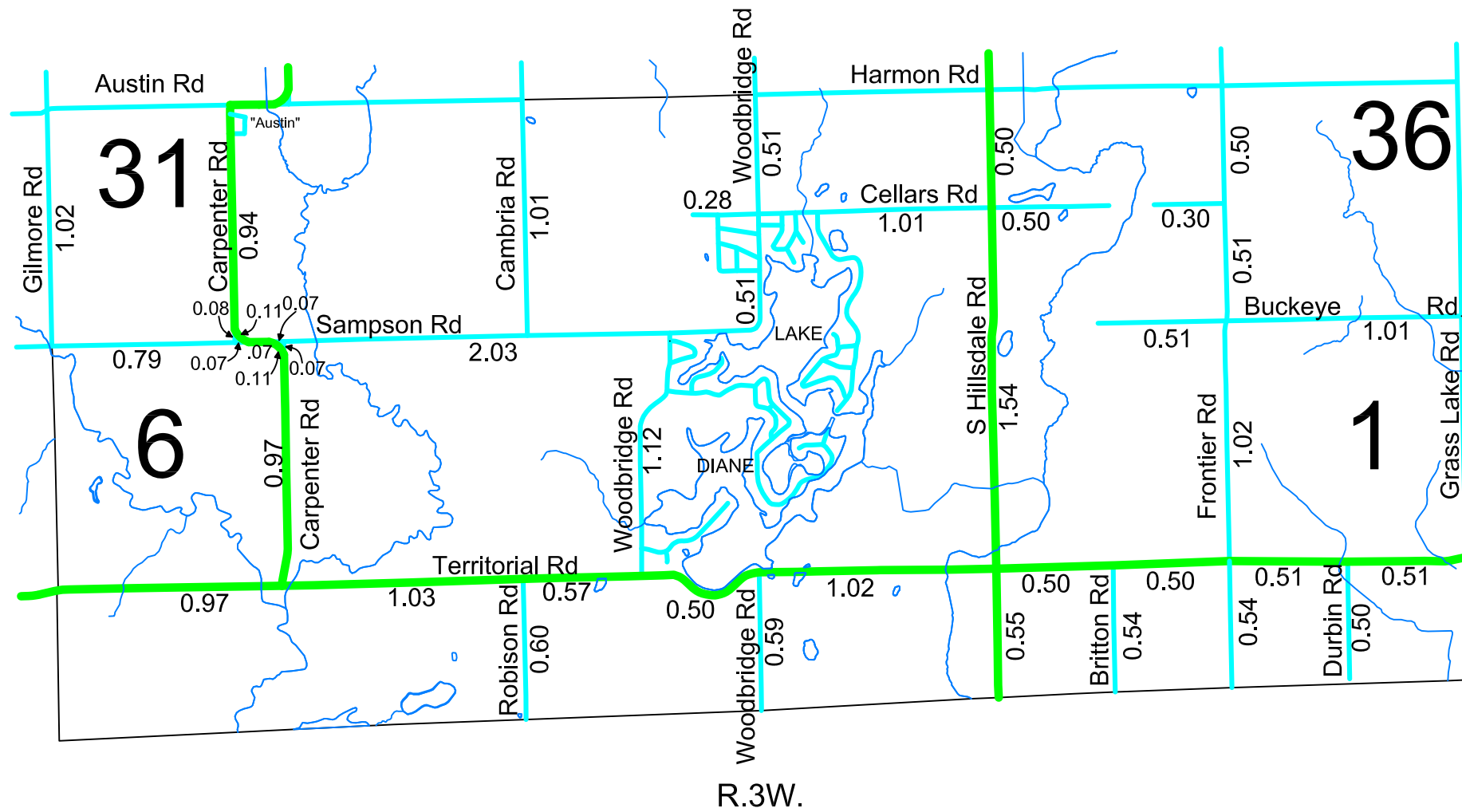

LEGEND

- Twp or County Line
- Corporate Limits
- State Trunkline
- County Primary
- County Local
- Adjacent County
- Railroad

T8S
↑
↓
T9S

Primary Road System is 16.93 miles.

Local Road System is 33.78 miles.

I HEREBY CERTIFY THAT THE ROADS SHOWN HEREON BY SYMBOL OR IN GREEN AS PRIMARY ROADS AND THOSE SHOWN HEREON BY SYMBOL OR IN BLUE AS LOCAL ROADS ARE IN USE AND ARE UNDER THE JURISDICTION OF THE COUNTY ROAD COMMISSION.

R.3W.

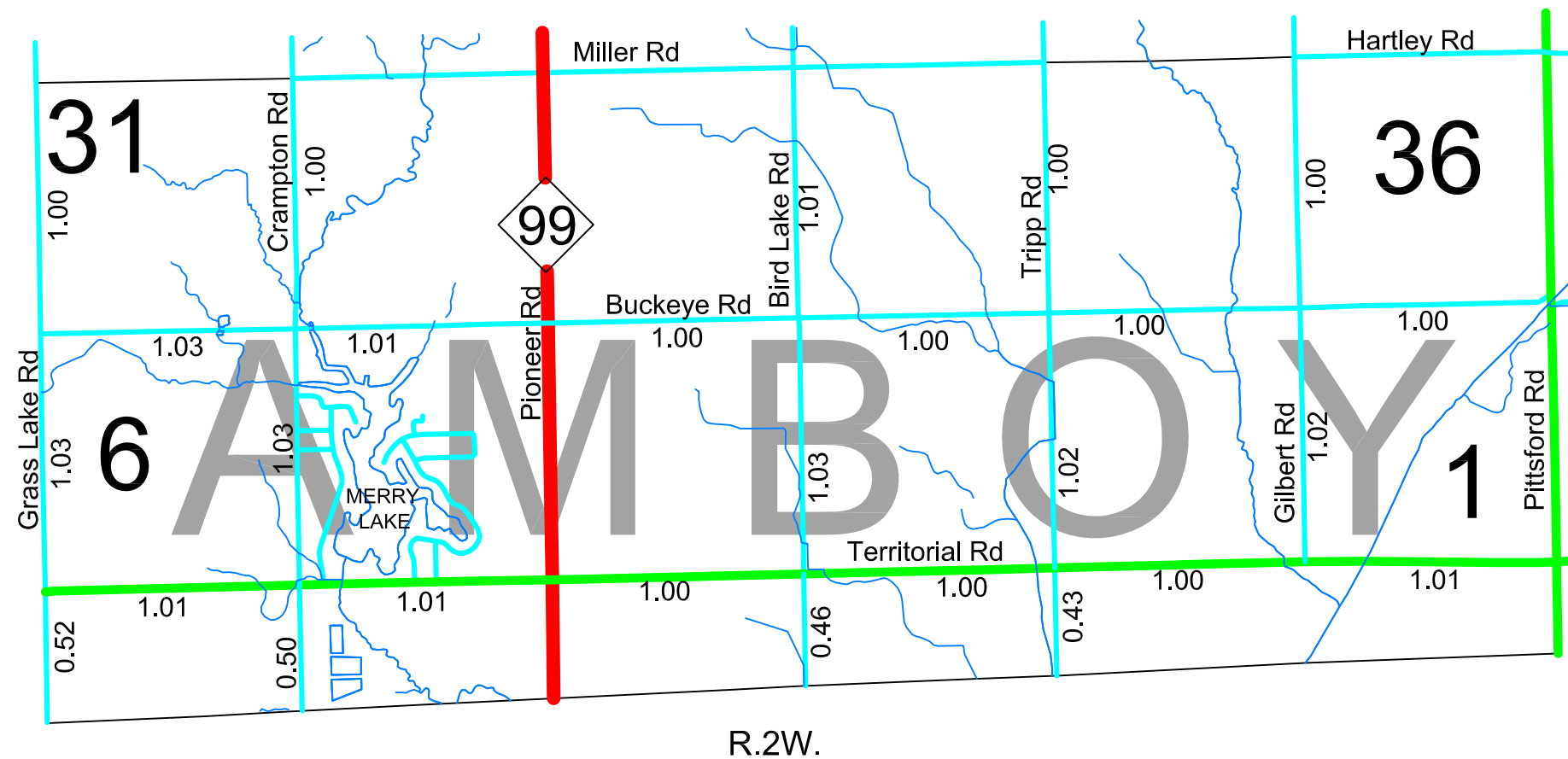

Chairman _____ Date _____

AMBOY TWP

T8S
↑
↓
T9S

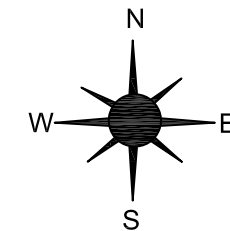

Scale: 1.5" = 1.0 miles

R.2W.

LEGEND

- Twp or County Line - - - - -
- Corporate Limits ————
- State Trunkline ————
- County Primary ————
- County Local ————
- Adjacent County XXXXXXXXXXXXXXXX

Total Feet 12,883 equals 2.44 miles.

I HEREBY CERTIFY THAT THE ROADS SHOWN HEREON BY SYMBOL OR IN BLUE AS LOCAL ROADS ARE IN USE AND ARE UNDER THE JURISDICTION OF THE COUNTY ROAD COMMISSION.

Chairman

Date

CAMBRIA TWP

Sections 1 & 2 T7S, R3W
Hillsdale County

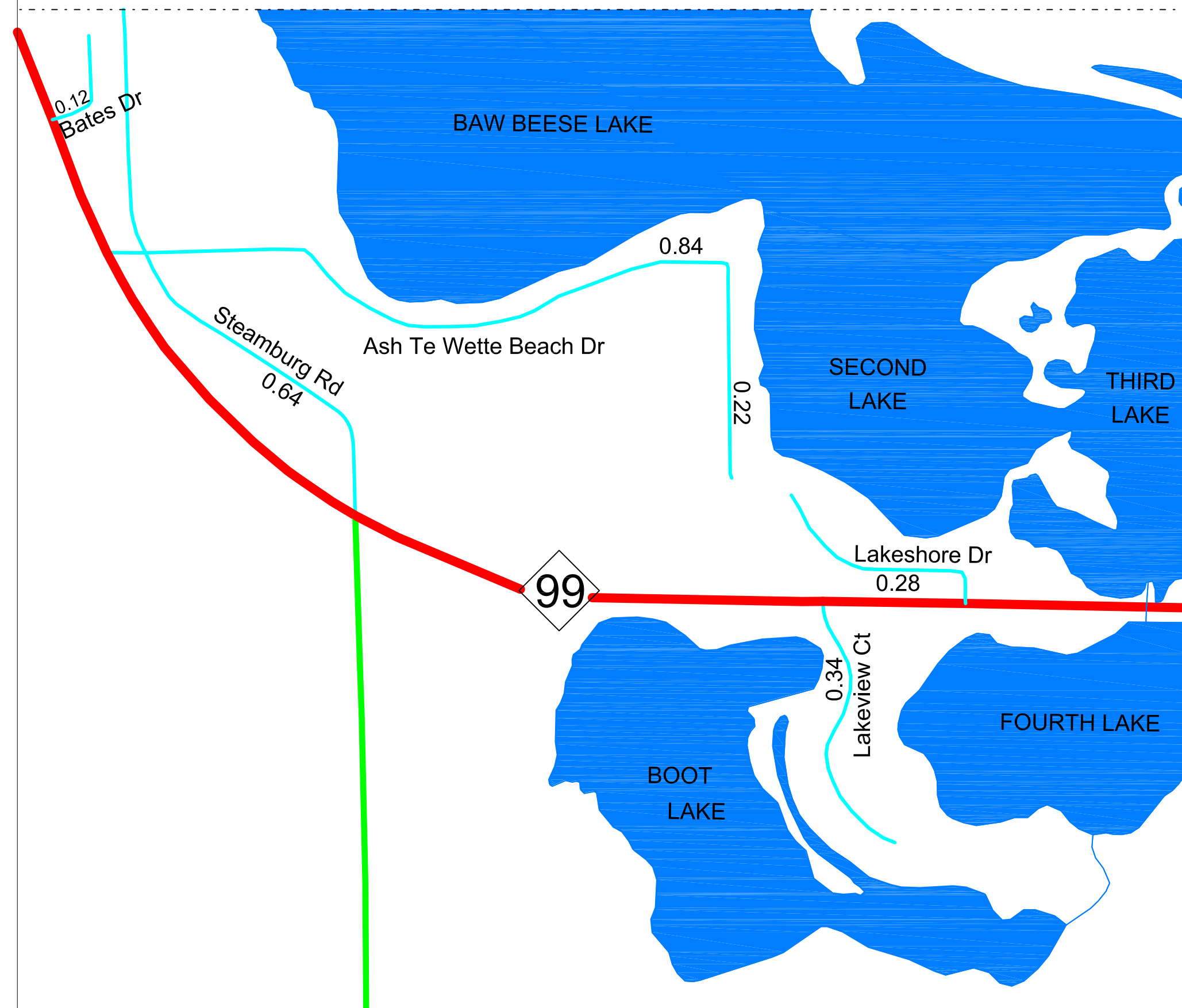
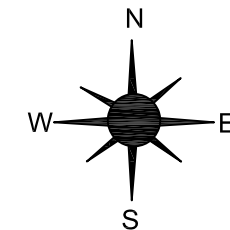

LEGEND

- Twp or County Line -----
- Corporate Limits _____
- State Trunkline **—————**
- County Primary **—————**
- County Local **—————**
- Adjacent County **XXXXXXXXXXXXXXXXXX**

Total Feet 1,109 equals 0.21 miles.

I HEREBY CERTIFY THAT THE ROADS SHOWN
HEREON BY SYMBOL OR IN BLUE AS LOCAL
ROADS ARE IN USE AND ARE UNDER THE
JURISDICTION OF THE COUNTY ROAD
COMMISSION.

Chairman

Date

CAMBRIA TWP

Section 34 T7S, R3W
Hillsdale County

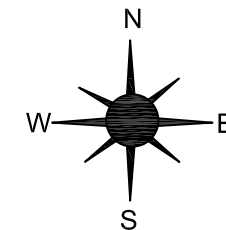

"Nicco Nook"

CUB
LAKE

Ohio St

0.04

0.06

Hillsdale St

0.11

Williams St

Hillsdale Rd

Steuben County, Indiana

Camden Rd

Todd Rd

Harts Plat of "Oak Grove Beach"

0.25

Maple St

LITTLE LONG LAKE

Cherry St
0.02

0.09

Oak St

LEGEND

- Twp or County Line -----
- Corporate Limits _____
- State Trunkline —————
- County Primary —————
- County Local —————
- Adjacent County XXXXXXXXXXXXXXXX

Total Feet 1,901 equals 0.36 miles.

I HEREBY CERTIFY THAT THE ROADS SHOWN HEREON BY SYMBOL OR IN BLUE AS LOCAL ROADS ARE IN USE AND ARE UNDER THE JURISDICTION OF THE COUNTY ROAD COMMISSION.

Chairman Date

CAMDEN TWP

Section 29 T8S, R4W
Hillsdale County

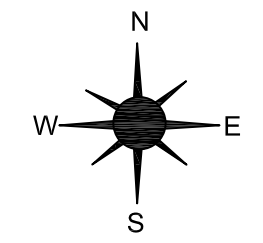

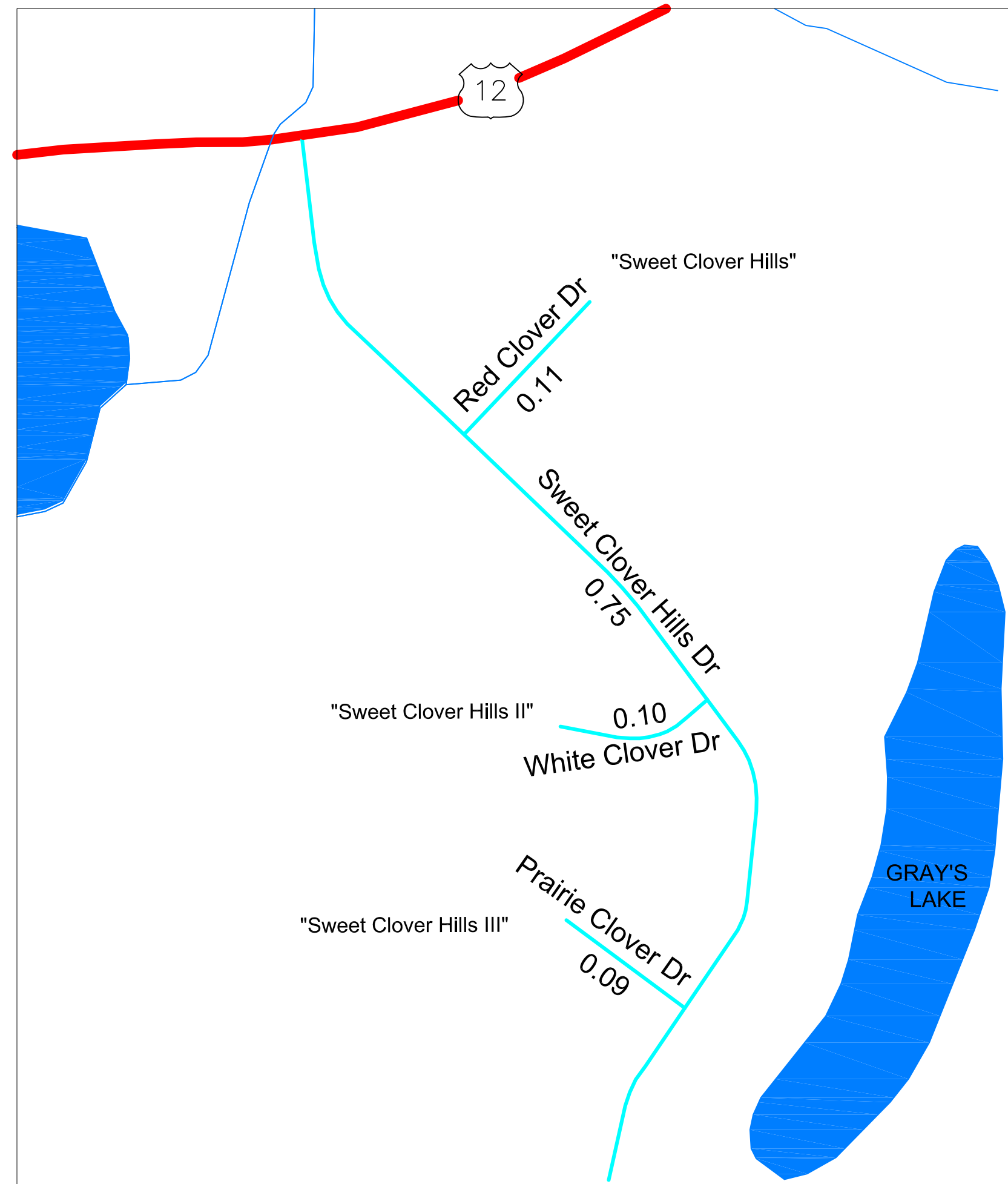

LEGEND

- Twp or County Line -----
- Corporate Limits _____
- State Trunkline **—————**
- County Primary **—————**
- County Local **—————**
- Adjacent County **XXXXXXXXXXXXXXXXXX**

Total Feet 5,548 equals 1.05 miles.

I HEREBY CERTIFY THAT THE ROADS SHOWN HEREON BY SYMBOL OR IN BLUE AS LOCAL ROADS ARE IN USE AND ARE UNDER THE JURISDICTION OF THE COUNTY ROAD COMMISSION.

Chairman Date

FAYETTE TWP

Section 35 T5S, R3W
Hillsdale County

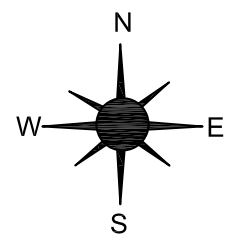

LEGEND

- Twp or County Line -----
- Corporate Limits _____
- State Trunkline —————
- County Primary —————
- County Local —————
- Adjacent County XXXXXXXXXXXXXXXX

Total Feet 12,831 equals 2.43 miles.

I HEREBY CERTIFY THAT THE ROADS SHOWN HEREON BY SYMBOL OR IN BLUE AS LOCAL ROADS ARE IN USE AND ARE UNDER THE JURISDICTION OF THE COUNTY ROAD COMMISSION.

Chairman

Date

HILLSDALE TWP

Sections 19, 20, 29, 30, 31 & 32
T6S, R3W
Hillsdale County

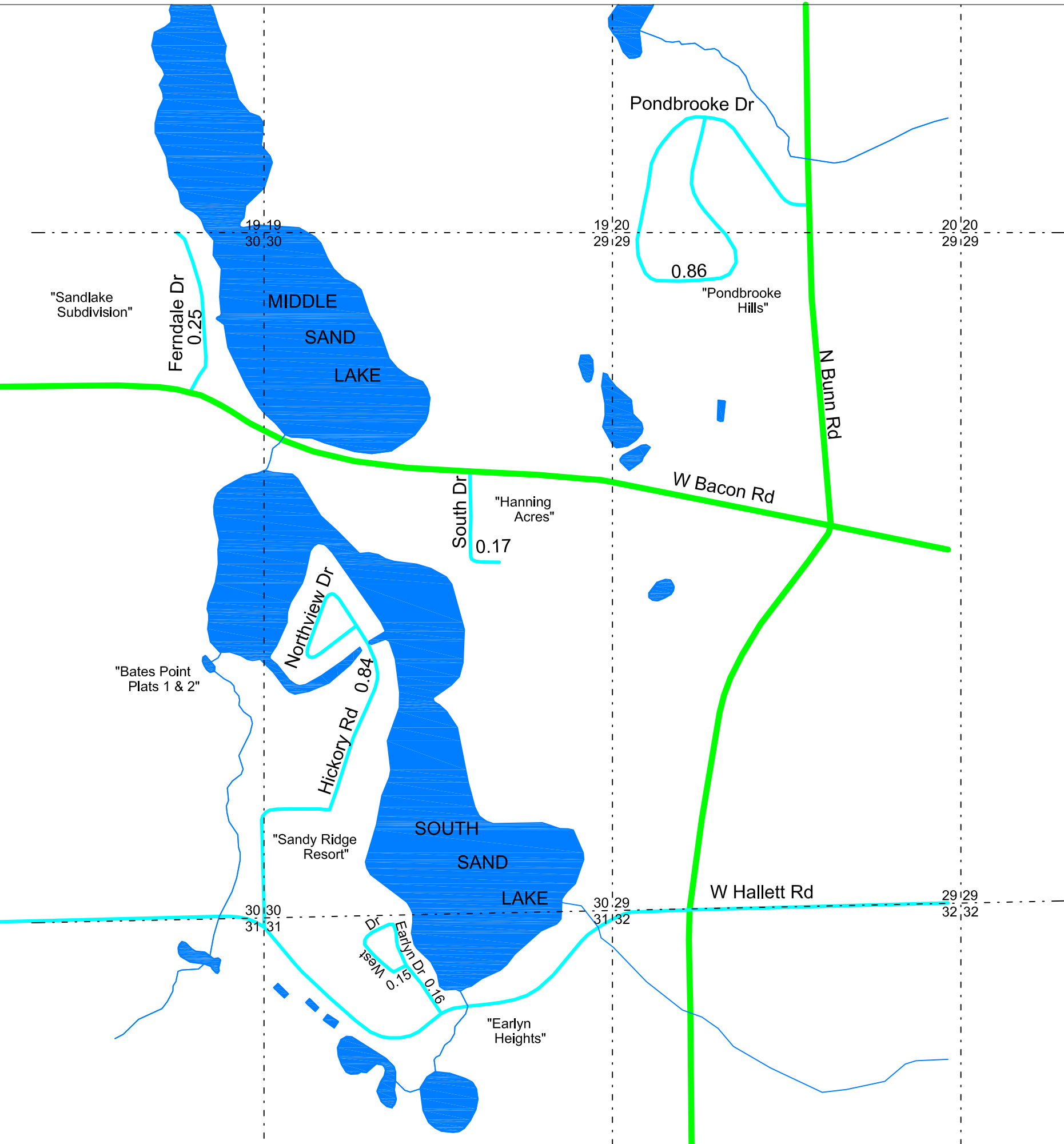
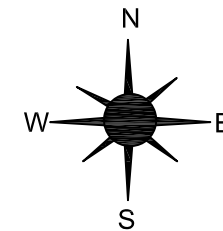

City of Hillsdale

"Baw Beese Heights"
"Baw Beese Heights #2"
"Juanita Heights"

Vera Dr
0.19

0.71

Lakeview Dr
0.12

Osborn Dr
0.29

Almeda Dr
Helen Dr
0.10

Ann St
0.07

99

Lanphere St
0.19

Juanita Dr
0.21

Steamburg Rd

0.43

Nakomis St
0.11

BAW
BEESE
LAKE

LEGEND

- Twp or County Line -----
- Corporate Limits _____
- State Trunkline —————
- County Primary —————
- County Local —————
- Adjacent County XXXXXXXXXXXXXXXX

Total Feet 12,778 equals 2.42 miles.

I HEREBY CERTIFY THAT THE ROADS SHOWN
HEREON BY SYMBOL OR IN BLUE AS LOCAL
ROADS ARE IN USE AND ARE UNDER THE
JURISDICTION OF THE COUNTY ROAD
COMMISSION.

Chairman Date

HILLSDALE TWP

Section 35 T6S, R3W
Hillsdale County

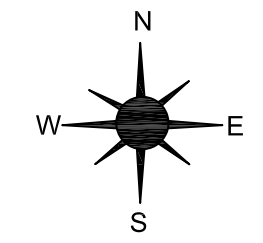

LEGEND

- Twp or County Line - - - - -
- Corporate Limits ————
- State Trunkline **————**
- County Primary **————**
- County Local ————
- Adjacent County XXXXXXXXXXXXXXXX

Total Primary Feet 950 equals 0.18 miles.
 Total Local Feet 11,510 equals 2.18 miles.

I HEREBY CERTIFY THAT THE ROADS SHOWN
 HEREON BY SYMBOL OR IN BLUE AS LOCAL
 ROADS ARE IN USE AND ARE UNDER THE
 JURISDICTION OF THE COUNTY ROAD
 COMMISSION.

_____ _____
 Chairman Date

JEFFERSON TWP

Section 4 T7S, R2W
 Hillsdale County

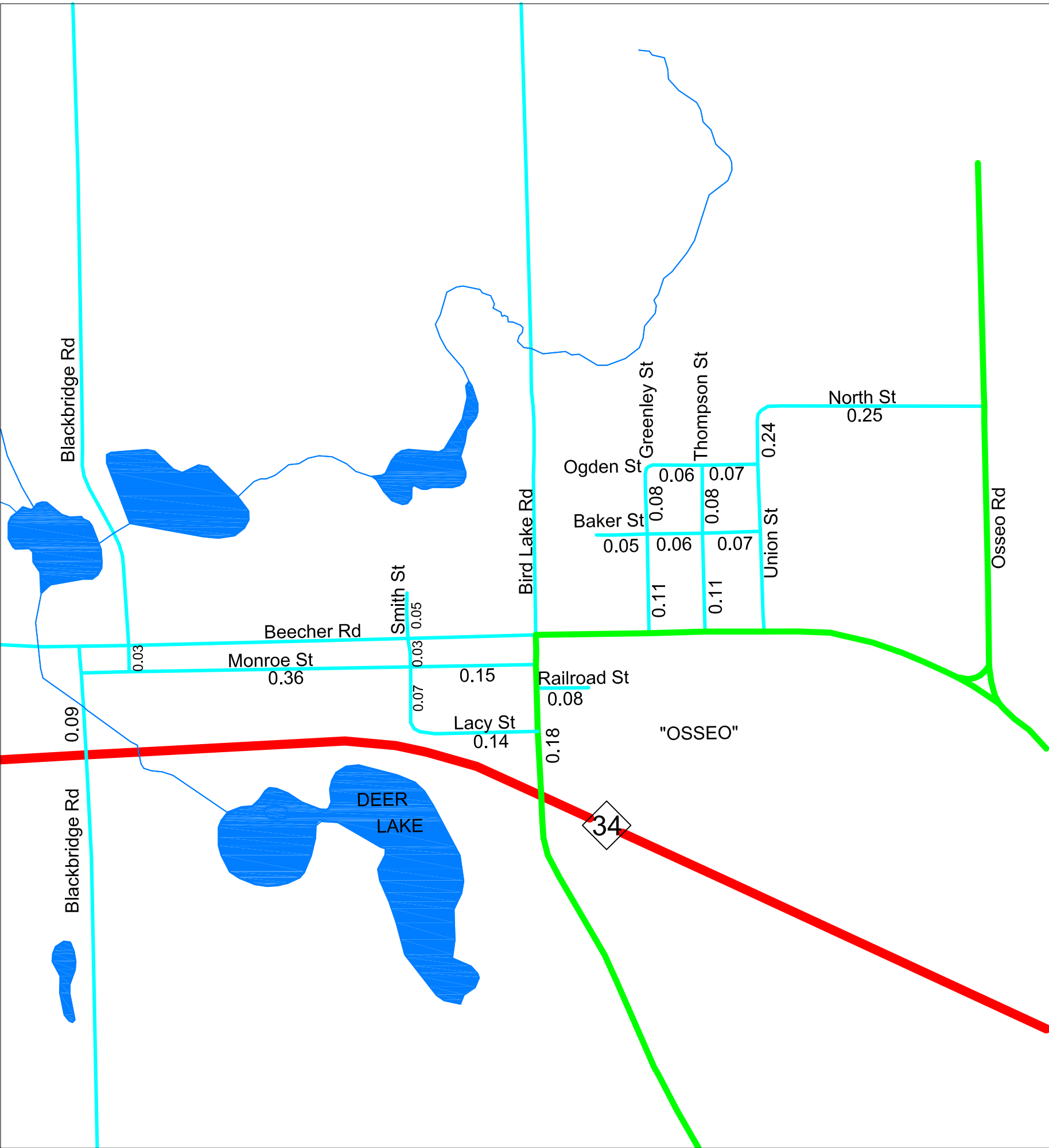
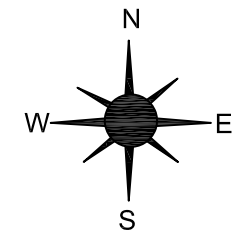

LEGEND

- Twp or County Line -----
- Corporate Limits _____
- State Trunkline **—————**
- County Primary **—————**
- County Local **—————**
- Adjacent County **XXXXXXXXXXXXXXXXXX**

Total Feet 12,091 equals 2.29 miles.

I HEREBY CERTIFY THAT THE ROADS SHOWN HEREON BY SYMBOL OR IN BLUE AS LOCAL ROADS ARE IN USE AND ARE UNDER THE JURISDICTION OF THE COUNTY ROAD COMMISSION.

Chairman

Date

PITTSFORD & JEFFERSON TWP

Sections 13 & 18 T7S, R1,2W

Hillsdale County

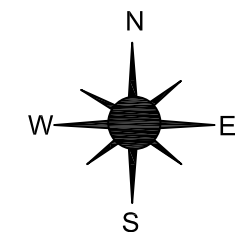

Jefferson Twp	1.03 Miles
Pittsford Twp	1.26 Miles
TOTAL	2.29 Miles

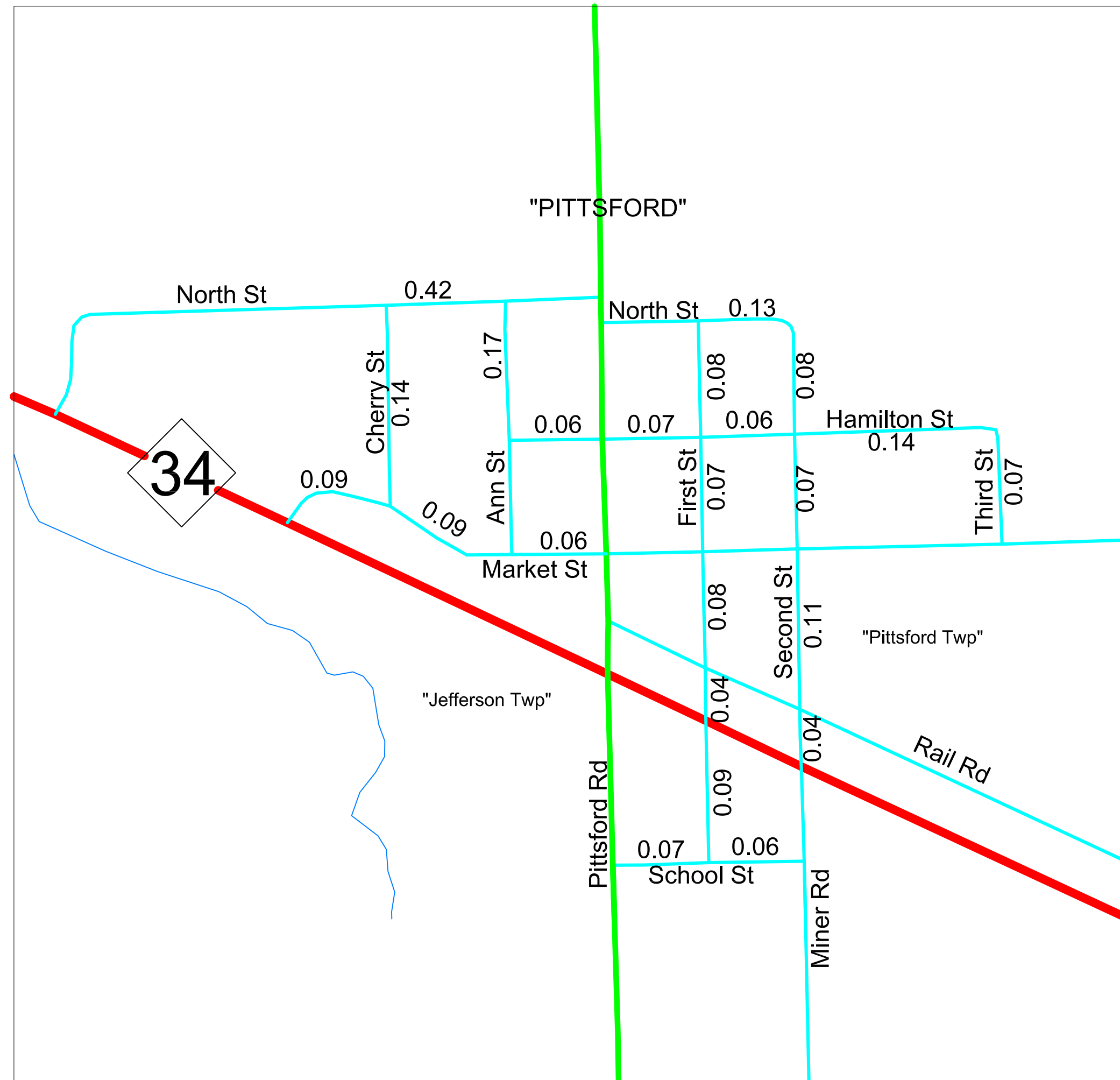

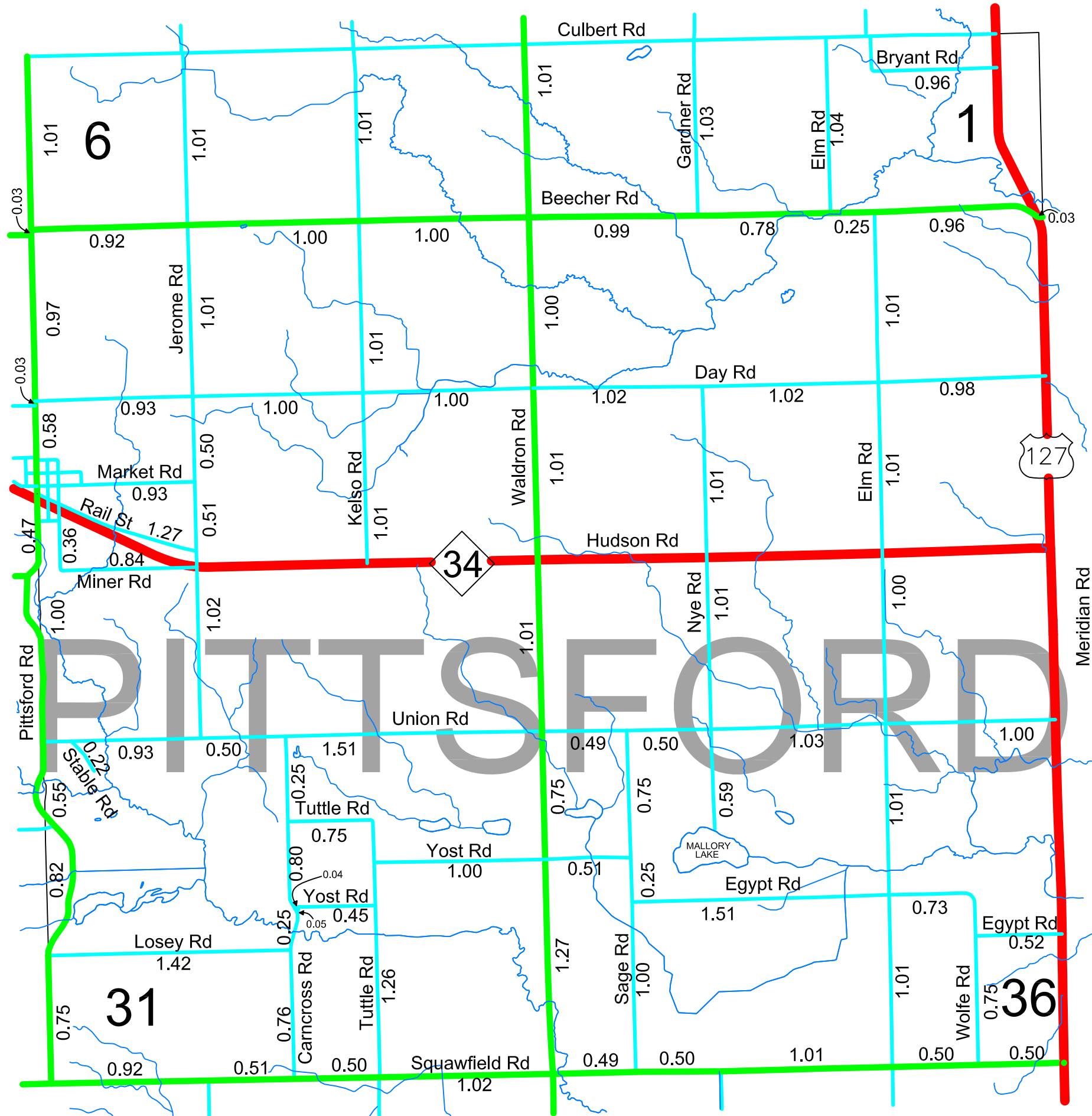

LEGEND

- Twp or County Line
- Corporate Limits
- State Trunkline
- County Primary
- County Local
- Adjacent County
- Railroad

Primary Road System is 24.14 miles.

Local Road System is 46.34 miles.

I HEREBY CERTIFY THAT THE ROADS SHOWN HEREON BY SYMBOL OR IN GREEN AS PRIMARY ROADS AND THOSE SHOWN HEREON BY SYMBOL OR IN BLUE AS LOCAL ROADS ARE IN USE AND ARE UNDER THE JURISDICTION OF THE COUNTY ROAD COMMISSION.

Chairman

Date

PITTSFORD TWP

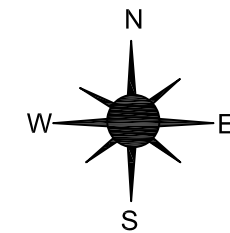

Scale: 1.5" = 1.0 miles

LEGEND

- Twp or County Line -----
- Corporate Limits _____
- State Trunkline —————
- County Primary —————
- County Local —————
- Adjacent County XXXXXXXXXXXXXXXX

Total Feet 1,003 equals 0.19 miles.

I HEREBY CERTIFY THAT THE ROADS SHOWN HEREON BY SYMBOL OR IN BLUE AS LOCAL ROADS ARE IN USE AND ARE UNDER THE JURISDICTION OF THE COUNTY ROAD COMMISSION.

Chairman

Date

RANSOM TWP

Section 16 T8S, R2W
Hillsdale County

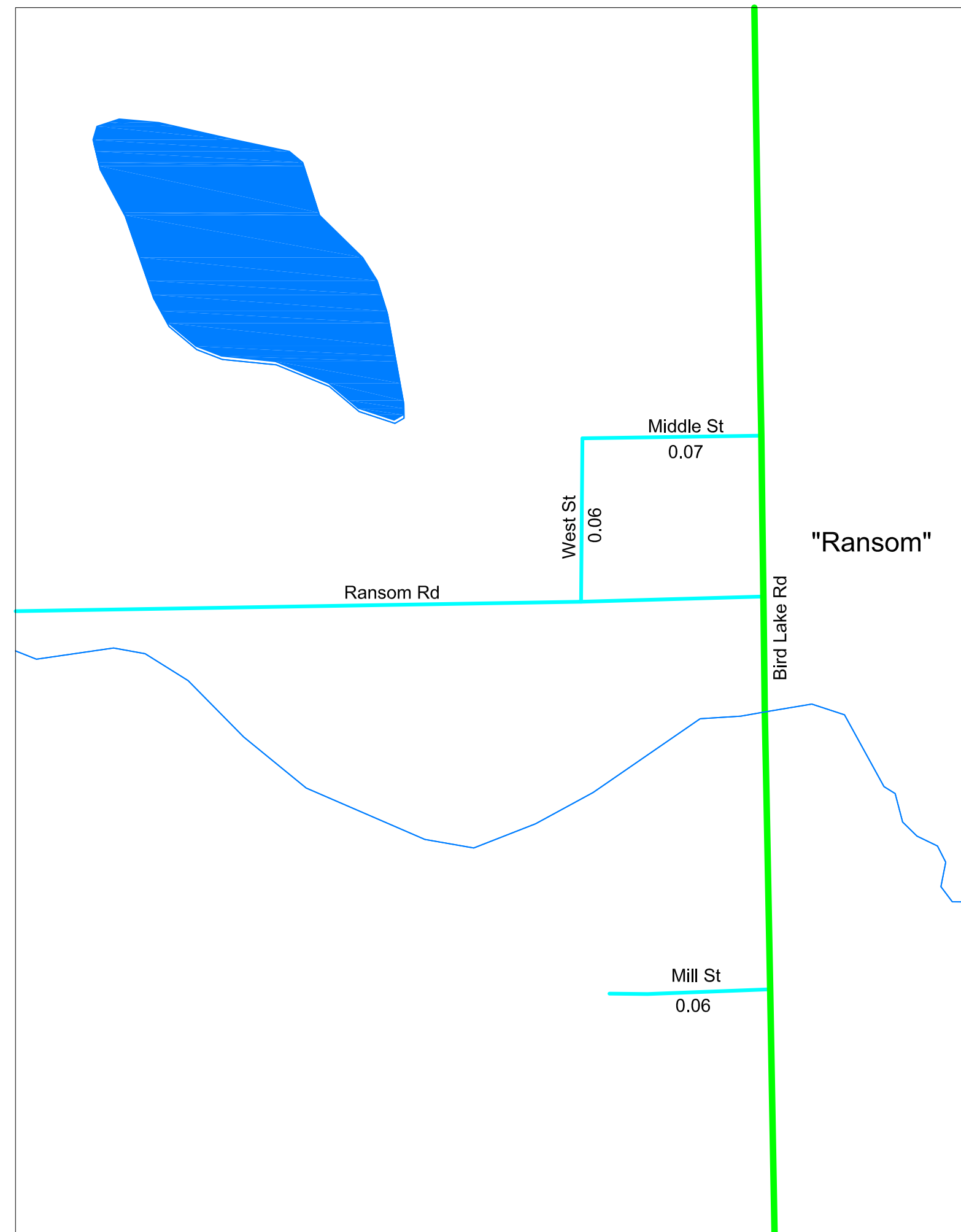
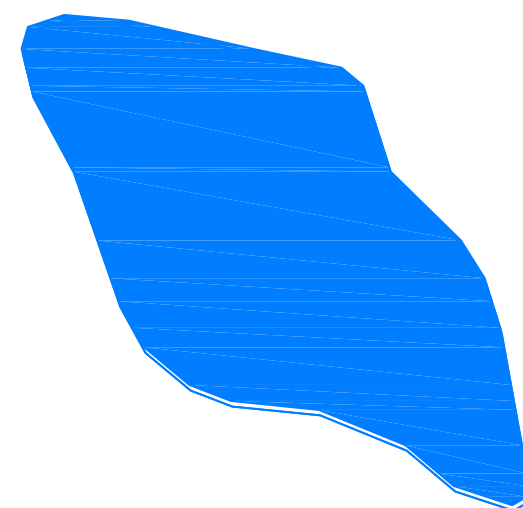
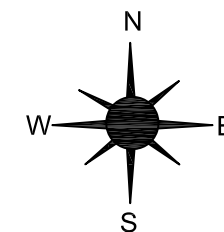

LEGEND

- Twp or County Line -----
- Corporate Limits _____
- State Trunkline **—————**
- County Primary **—————**
- County Local _____
- Adjacent County XXXXXXXXXXXXXXXX

Total Feet 5,386 equals 1.02 miles.

I HEREBY CERTIFY THAT THE ROADS SHOWN HEREON BY SYMBOL OR IN BLUE AS LOCAL ROADS ARE IN USE AND ARE UNDER THE JURISDICTION OF THE COUNTY ROAD COMMISSION.

Chairman

Date

READING TWP

Section 20 T7S, R4W
Hillsdale County

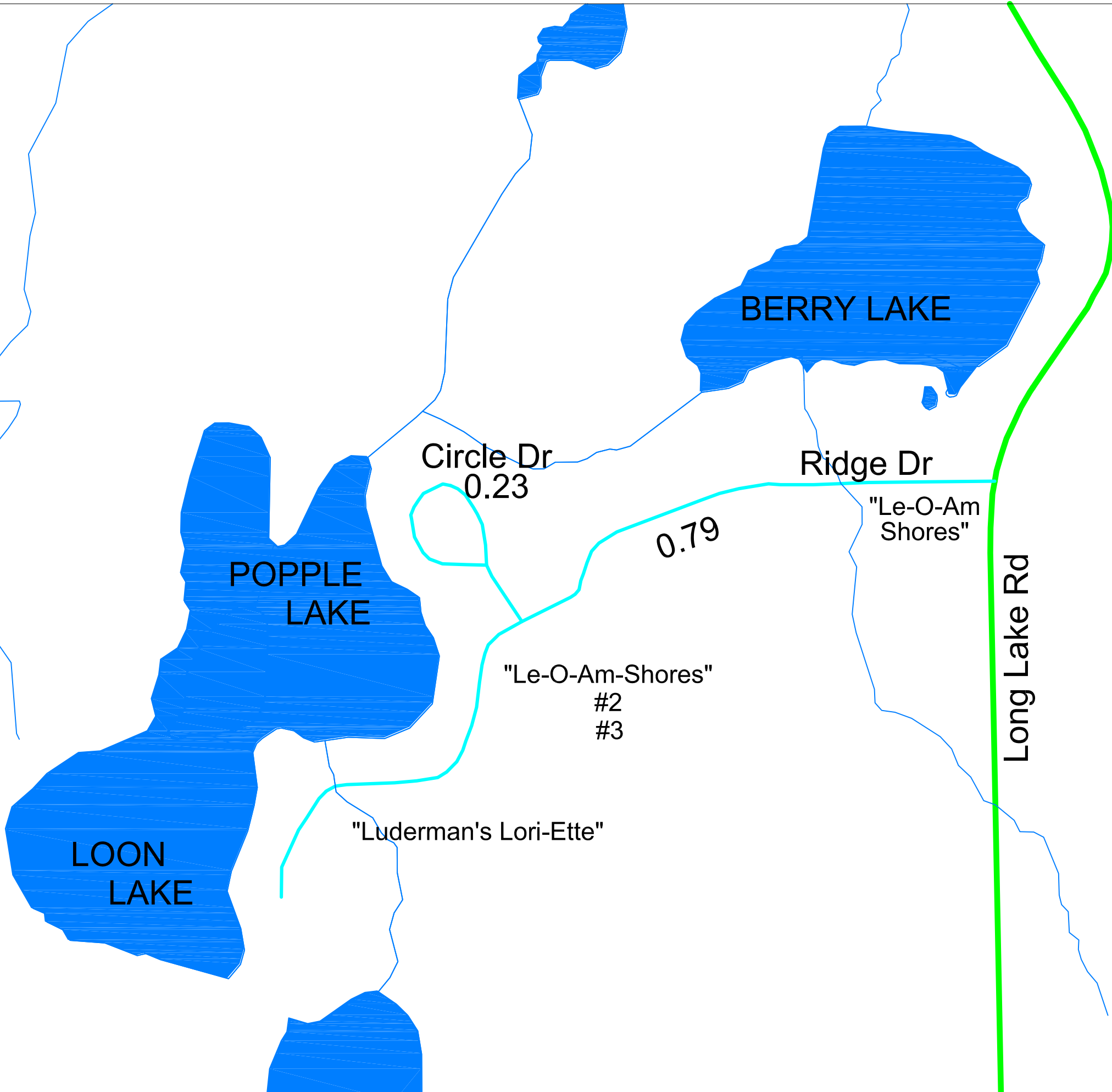
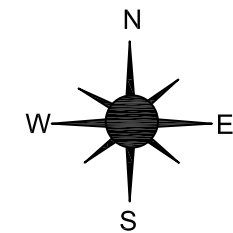

LEGEND

- Twp or County Line -----
- Corporate Limits _____
- State Trunkline —————
- County Primary —————
- County Local —————
- Adjacent County XXXXXXXXXXXXXXXXXX

Total Feet 3,366 equals 0.64 miles.

I HEREBY CERTIFY THAT THE ROADS SHOWN HEREON BY SYMBOL OR IN BLUE AS LOCAL ROADS ARE IN USE AND ARE UNDER THE JURISDICTION OF THE COUNTY ROAD COMMISSION.

Chairman

Date

READING TWP

Section 31 T7S, R4W
Hillsdale County

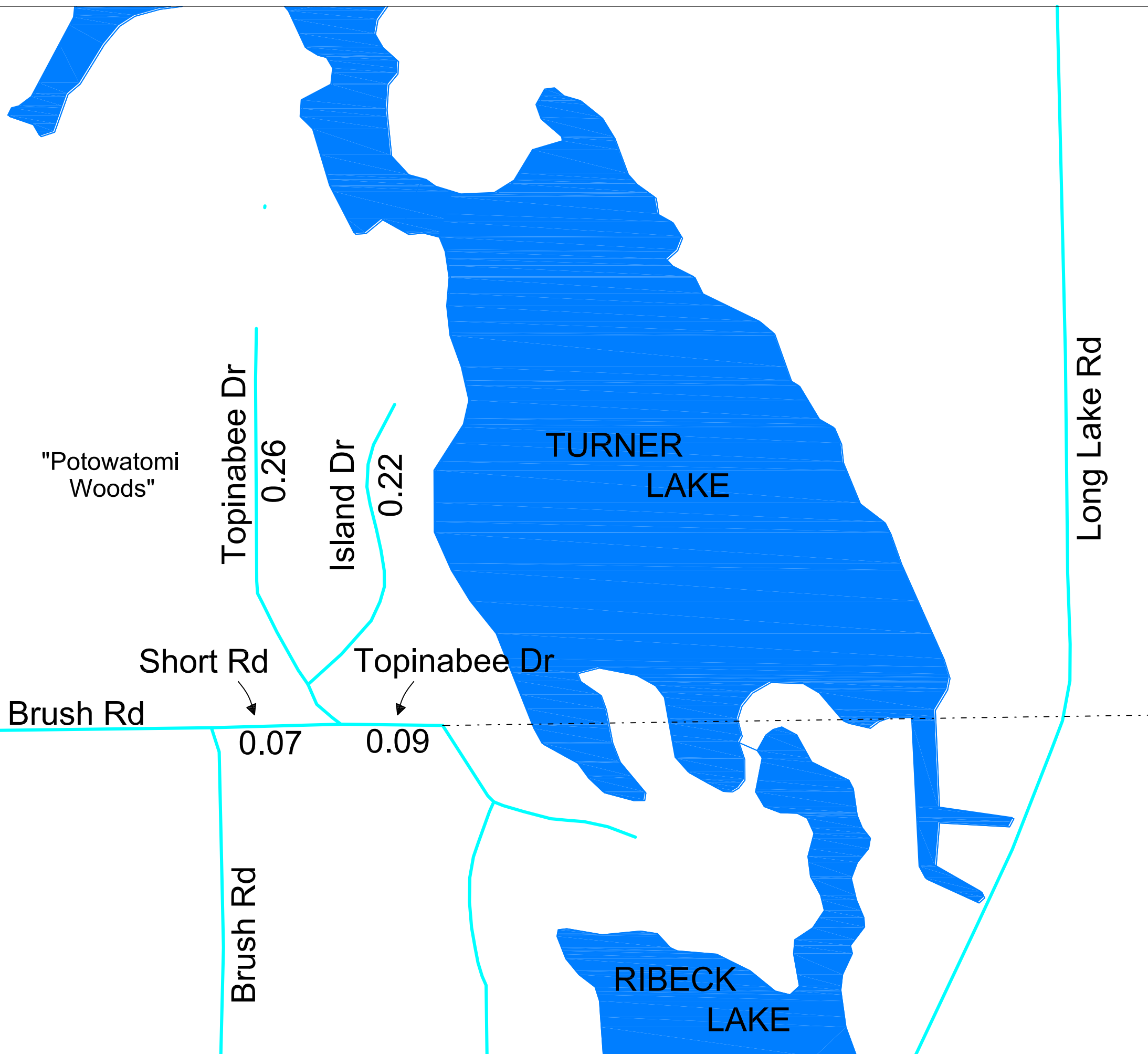
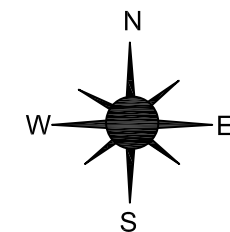

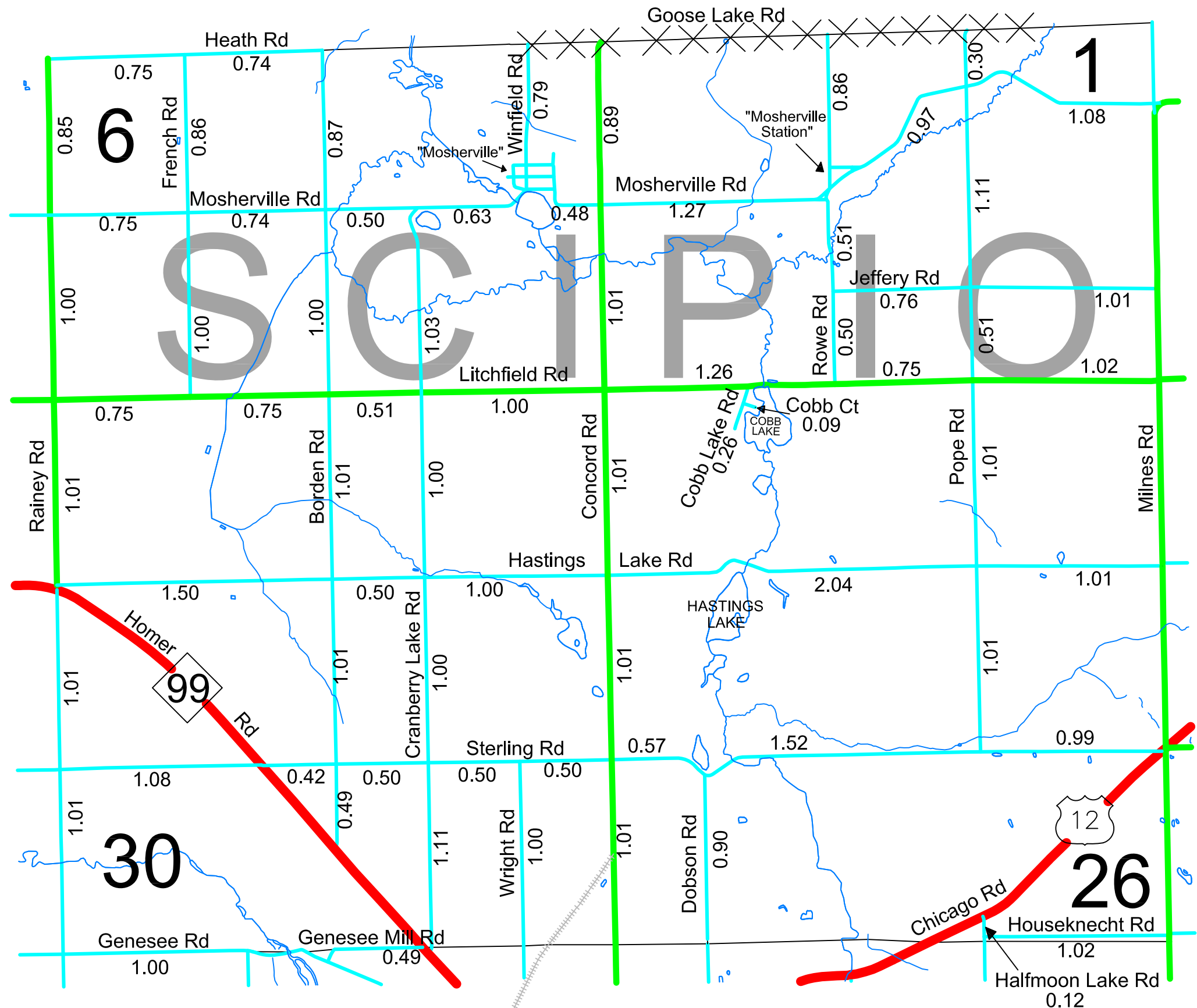

LEGEND

- Twp or County Line
- Corporate Limits
- State Trunkline
- County Primary
- County Local
- Adjacent County
- Railroad

Primary Road System is 13.83 miles.

Local Road System is 45.69 miles.

I HEREBY CERTIFY THAT THE ROADS SHOWN HEREON BY SYMBOL OR IN GREEN AS PRIMARY ROADS AND THOSE SHOWN HEREON BY SYMBOL OR IN BLUE AS LOCAL ROADS ARE IN USE AND ARE UNDER THE JURISDICTION OF THE COUNTY ROAD COMMISSION.

Chairman

Date

SCIPIO TWP

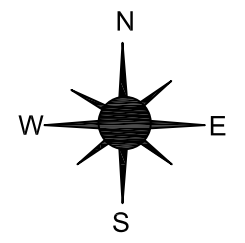

Scale: 1.5" = 1.0 miles

LEGEND

- Twp or County Line -----
- Corporate Limits _____
- State Trunkline —————
- County Primary —————
- County Local —————
- Adjacent County XXXXXXXXXXXXXXXXXX

Total Feet 4,120 equals 0.78 miles.

I HEREBY CERTIFY THAT THE ROADS SHOWN HEREON BY SYMBOL OR IN BLUE AS LOCAL ROADS ARE IN USE AND ARE UNDER THE JURISDICTION OF THE COUNTY ROAD COMMISSION.

Chairman

Date

SCIPPIO TWP

Section 4 T5S, R3W
Hillsdale County

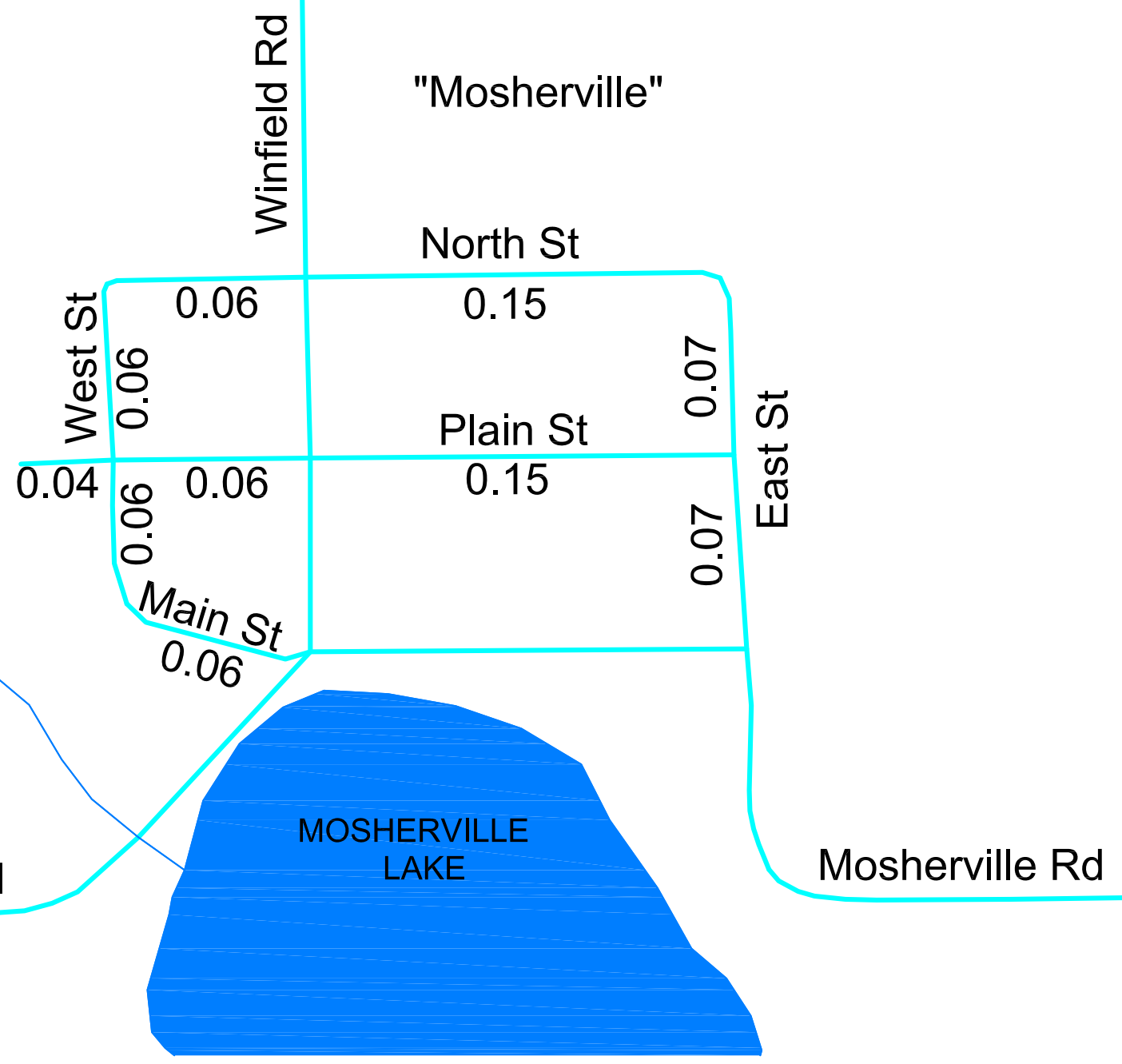
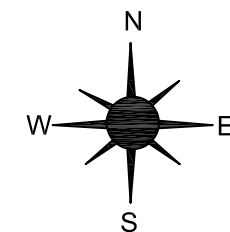

LEGEND

- Twp or County Line
- Corporate Limits
- State Trunkline
- County Primary
- County Local
- Adjacent County XXXXXXXXXXXXXXXXXX

Total Feet 75,824 equals 14.55 miles.

I HEREBY CERTIFY THAT THE ROADS SHOWN
HEREON BY SYMBOL OR IN BLUE AS LOCAL
ROADS ARE IN USE AND ARE UNDER THE
JURISDICTION OF THE COUNTY ROAD
COMMISSION.

Chairman

Date

SOMERSET TWP

Sections 3-5 & 8-10
T5S, R1W
Hillsdale County

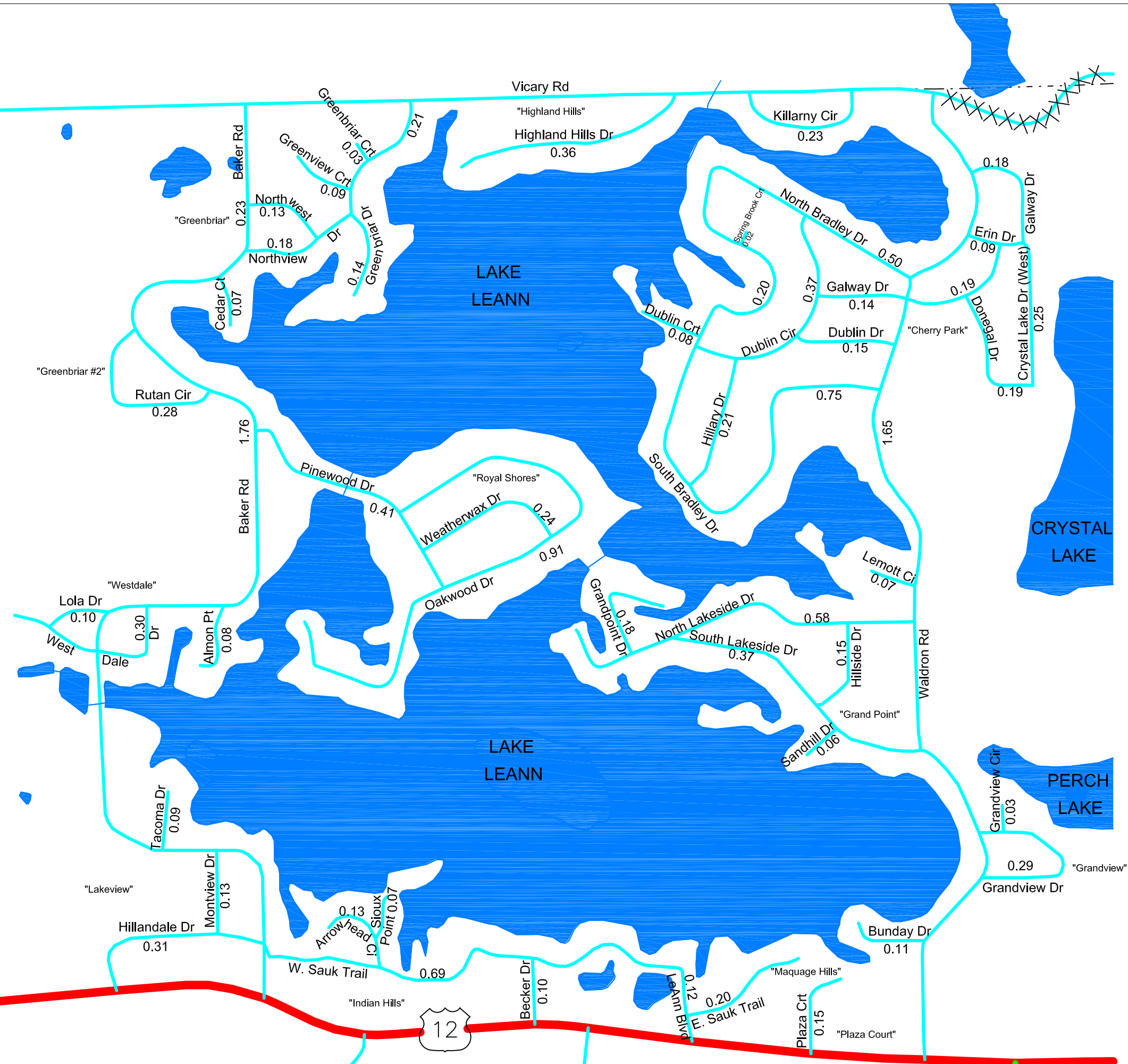
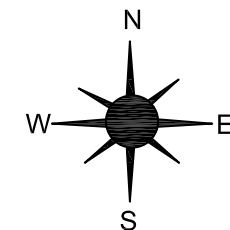

LEGEND

- Twp or County Line -----
- Corporate Limits _____
- State Trunkline —————
- County Primary —————
- County Local —————
- Adjacent County XXXXXXXXXXXXXXXXXX

Total Feet 2,535 equals 0.48 miles.

I HEREBY CERTIFY THAT THE ROADS SHOWN HEREON BY SYMBOL OR IN BLUE AS LOCAL ROADS ARE IN USE AND ARE UNDER THE JURISDICTION OF THE COUNTY ROAD COMMISSION.

Chairman

Date

WOODBRIIDGE TWP

Section 12 T8S, R3W

Hillsdale County

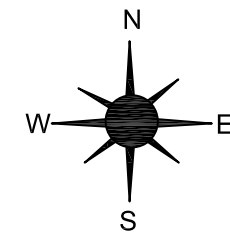

"Frontier"

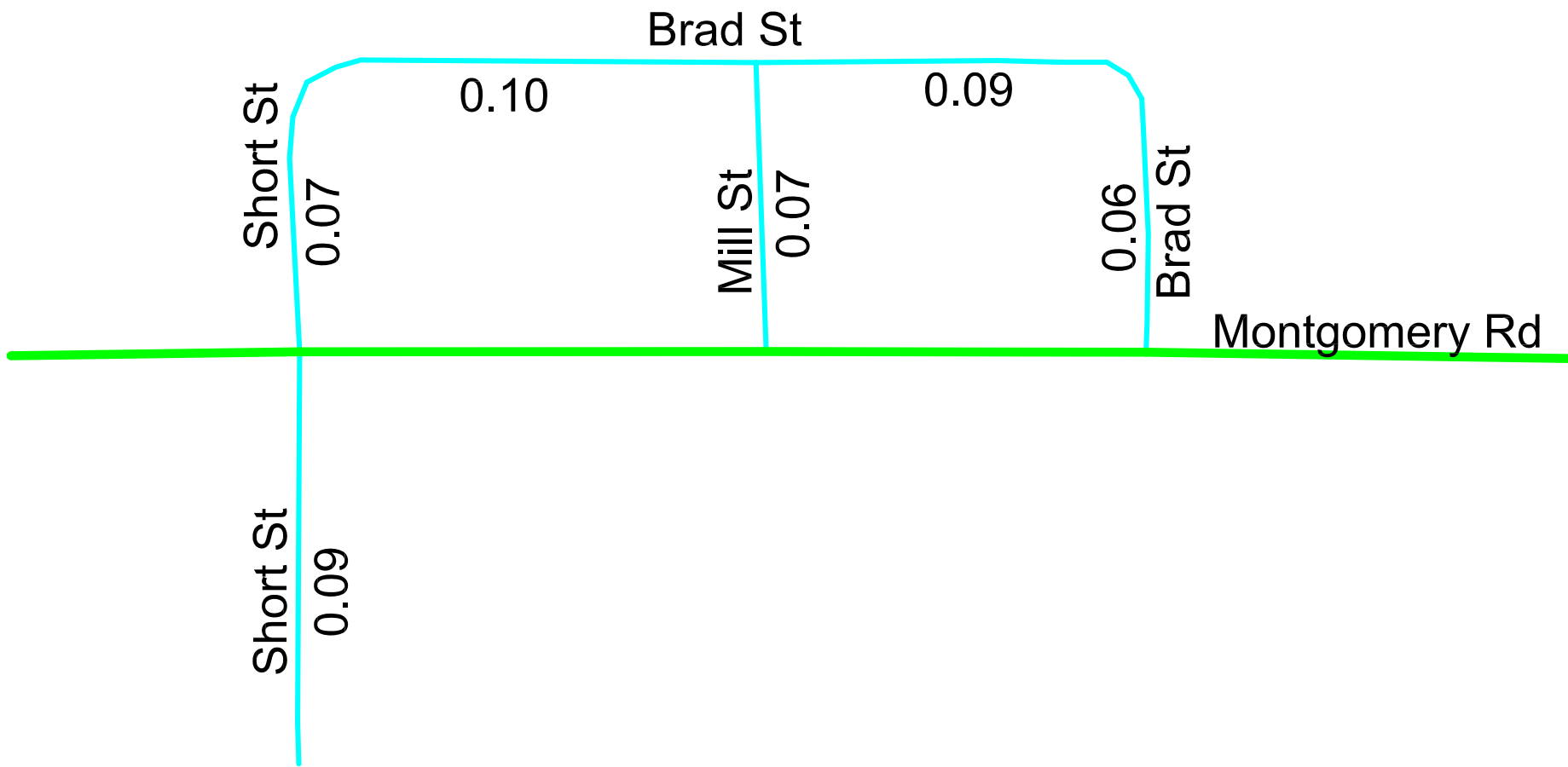

LEGEND

- Twp or County Line -----
- Corporate Limits _____
- State Trunkline —————
- County Primary —————
- County Local —————
- Adjacent County XXXXXXXXXXXXXXXX

Total Feet 2,587 equals 0.49 miles.

I HEREBY CERTIFY THAT THE ROADS SHOWN HEREON BY SYMBOL OR IN BLUE AS LOCAL ROADS ARE IN USE AND ARE UNDER THE JURISDICTION OF THE COUNTY ROAD COMMISSION.

Chairman

Date

WRIGHT TWP

Section 15 T8S, R1W

Hillsdale County

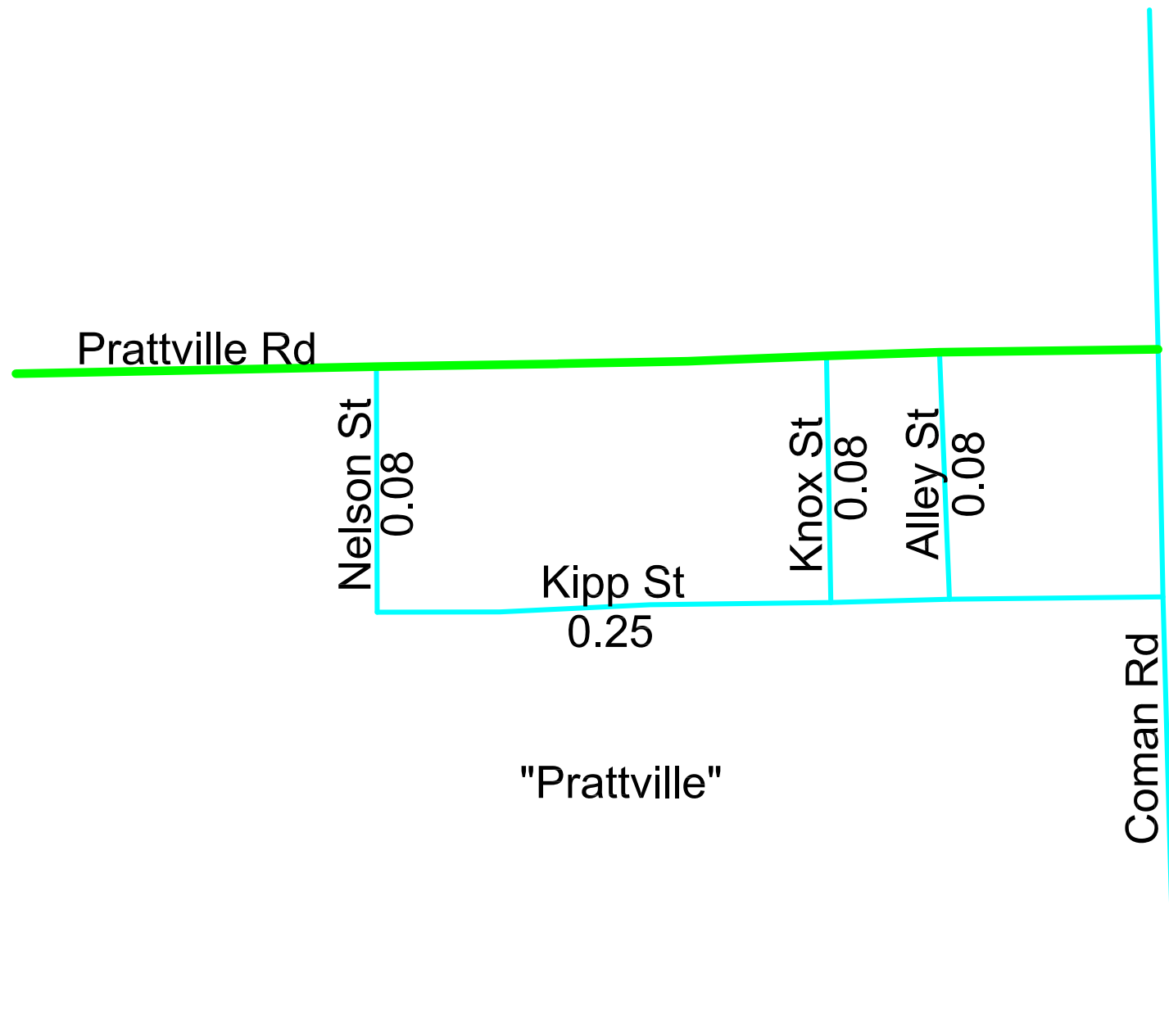
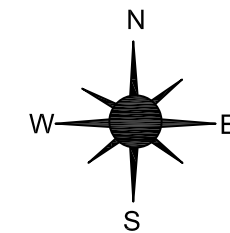

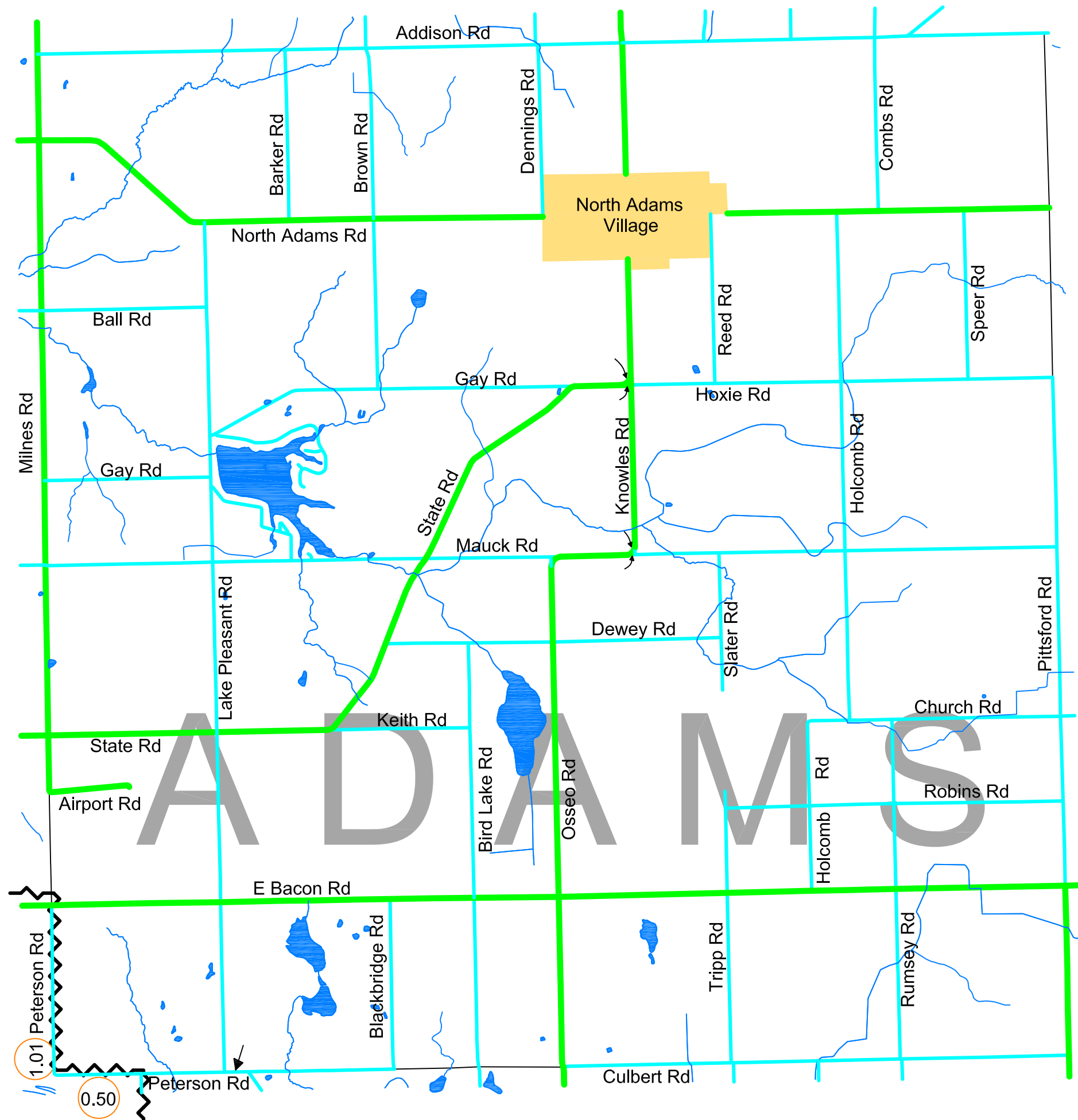

LEGEND

- Twp or County Line
- Corporate Limits
- State Trunkline
- County Primary
- County Local
- Adjacent County
- Urban Boundary
- Railroad

Urban Area Certification

Urban Primary Road System is 0.00 miles
 Urban Local Road System is 1.51 miles.

I HEREBY CERTIFY THAT THE ROADS SHOWN HEREON BY SYMBOL OR IN GREEN AS PRIMARY ROADS AND THE ROADS SHOWN HEREON BY SYMBOL OR IN BLUE AS LOCAL ROADS ARE IN USE AND ARE UNDER THE JURISDICTION OF THE COUNTY ROAD COMMISSION.

Chairman

Date

ADAMS TWP

Section 17, T6S, R2W
 Hillsdale County

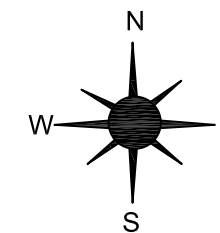

Scale: 1.5" = 1.0 miles

LEGEND

- Twp or County Line
- Corporate Limits
- State Trunkline
- County Primary
- County Local
- Adjacent County
- Urban Boundary

Urban Area Certification

Urban Primary Road System is 0.00 miles
 Urban Local Road System is 2.42 miles.

I HEREBY CERTIFY THAT THE ROADS SHOWN
 HEREON BY SYMBOL OR IN GREEN AS
 PRIMARY ROADS AND THE ROADS SHOWN
 HEREON BY SYMBOL OR IN BLUE AS LOCAL
 ROADS ARE IN USE AND ARE UNDER THE
 JURISDICTION OF THE COUNTY ROAD
 COMMISSION.

 Chairman

 Date

HILLSDALE TWP

Section 35 T6S, R3W

Hillsdale County

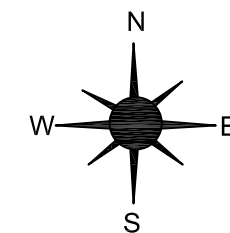

"Baw Beese Heights"
 "Baw Beese Heights #2"
 "Juanita Heights"

City of Hillsdale

BAW
 BEESE
 LAKE

Vera Dr

0.19

Osborn Dr

0.29

Almeda Dr

0.10

Lanphere St

0.19

0.43

0.11

Helen Dr

Ann St

0.07

Juanita Dr

0.21

Nakomis St

Steamburg Rd

0.71

Lakeview Dr

0.12



